

## Kozijn maten

AV-40 LD met Z-kozijn	40mm	KD = 55mm
AV-60-LD met Z-kozijn	60mm	KD = 74mm
AV-80-LD met Z-kozijn	80mm	KD = 94mm
AV-100-LD met Z-kozijn	100mm	KD = 114mm
Kozijnbreedte	KB	DMB - 10mm
Kozijnhoogte	KH	DMH - 10mm
Dagmaatbreedte	DMB	
Dagmaathoogte	DMH	

## Loopdeur met onderdorpel

Vrije doorloopbreedte	VDB	KB - 45mm
Vrije doorloophoogte	VDH	KH - 45mm
Kozijnbuitenmaat, Breedte	BM	KB + 80mm
Kozijnbuitenmaat, Hoogte	HM	KH + 80mm

## Loopdeur zonder dorpel

Vrije doorloopbreedte	VDB	KB - 45mm
Vrije doorloophoogte	VDH	KH - 23mm
Kozijnbuitenmaat, Breedte	BM	KB + 80mm
Kozijnbuitenmaat, Hoogte	HM	KH + 40mm

## Loopdeur met dorpel zonder voorflens

Vrije doorloopbreedte	VDB	KB - 45mm
Vrije doorloophoogte	VDH	KH - 45mm
Kozijnbuitenmaat, Breedte	BM	KB + 80mm
Kozijnbuitenmaat, Hoogte	HM	KH + 40mm

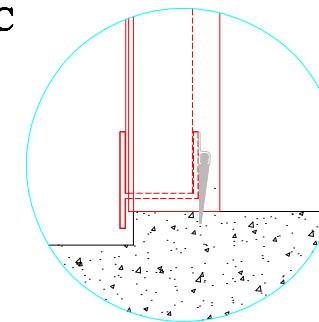
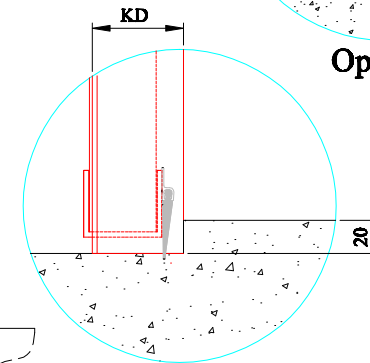
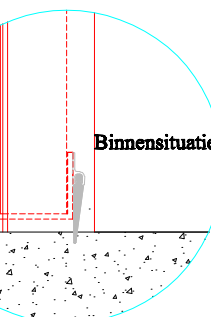
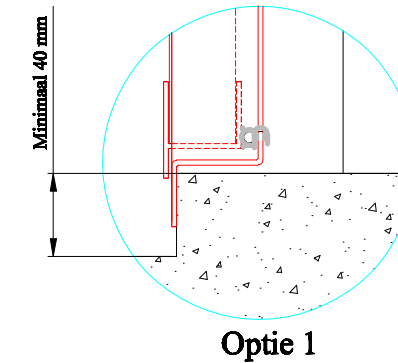
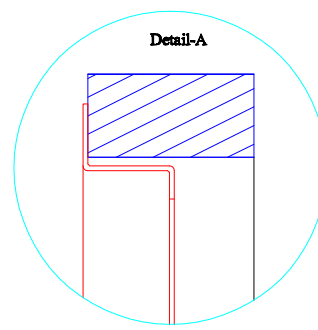
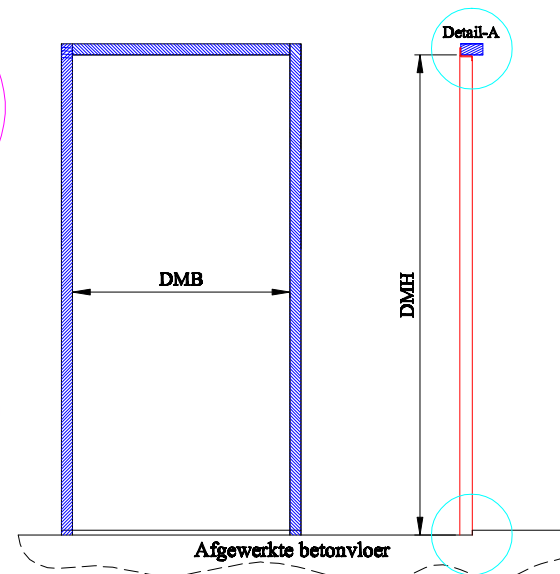
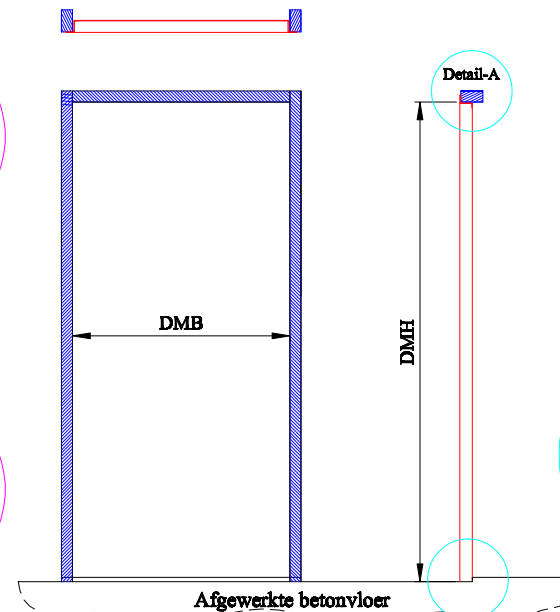
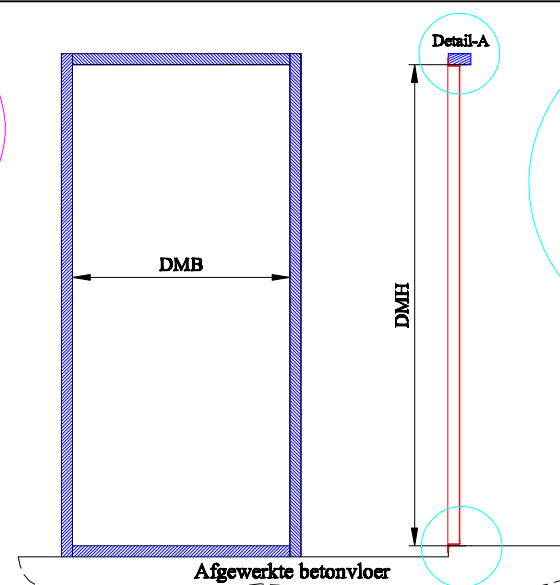
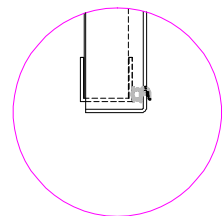
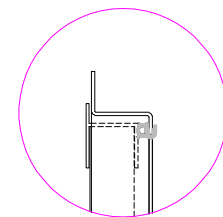
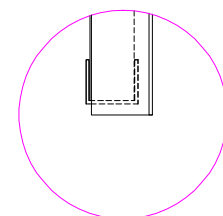
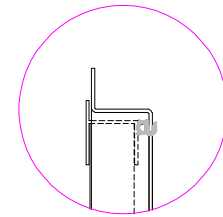
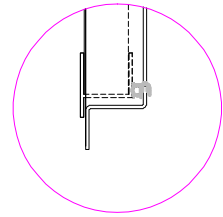
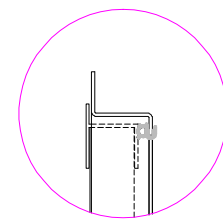
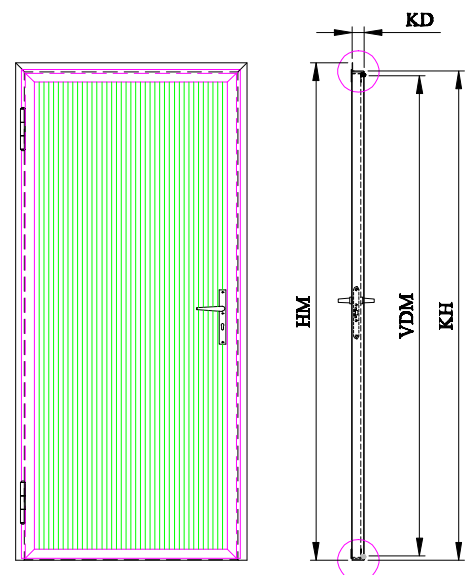
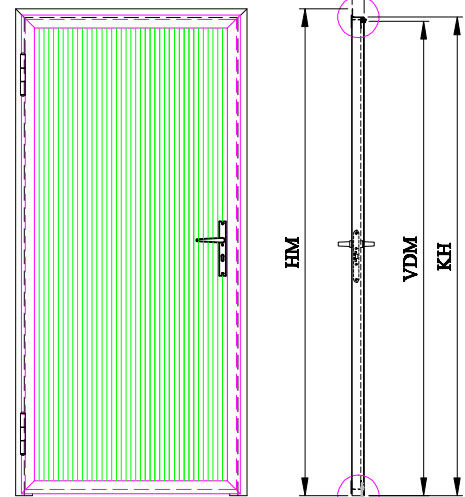
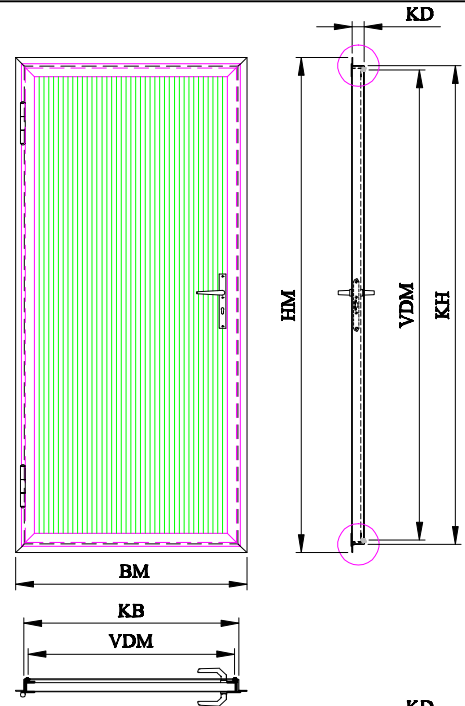

Optie 2A

Optie 2B

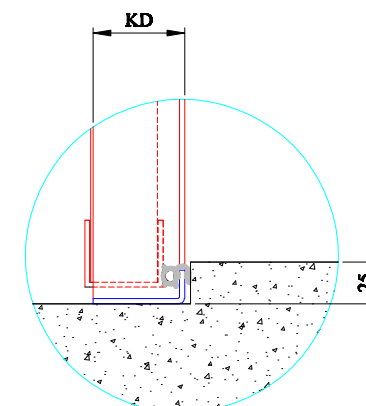

Optie 3